

- 128'-8" Top Of Elevator Bulkhead
- 123'-4" Top Of Mechanical Roof
- 115'-7" Top Of Railing
- 110'-9" Roof
- 99'-6" Floor 12
- 90'-9" Floor 11
- 82'-0" Floor 10
- 73'-3" Floor 9
- 64'-8" Floor 8
- 55'-9" Floor 7
- 47' Floor 6
- 38'-3" Floor 5
- 33'-10" Top Of Railing
- 31'-9" Top Of Parapet
- 29'-6" Floor 4
- 20'-9" Floor 3
- 12' Floor 2
- 0' (Elev. 16'-1 1/4") Floor 1
- VARIES Grade



1 West Elevation
 Scale: 1/8" = 1'-0"
 0 10 20 30 FT

MATERIAL LEGEND

	EIFS
	STAINLESS STEEL
	METAL PANEL
	BRICK, TYPE A
	BRICK, TYPE B

Architects:
Kiss + Cathcart, Architects
 44 Court Street, Tower C
 Brooklyn, NY 11201
 (718) 237-2786 phone / (718) 237-2025 fax

MEP Engineers:
Goldman Copeland Associates
 520 Eighth Avenue
 New York, NY 10018
 (212) 868-4660 phone / (212) 868-4680 fax

Structural Engineers:
Robert Silman Associates
 88 University Place
 New York, NY 10003
 (212) 620-7970 phone / (212) 620-8157 fax

Landscape:
Donna Walcavage Landscape and Urban Design
 212 Hicks Street
 Brooklyn, NY 11201
 (718) 834-0224 phone / (718) 834-9102 fax

Lighting:
AWA Architectural Lighting Designers
 504 LaGuardia Place, 5th Floor
 New York, NY 10012
 (212) 473-9797 phone / (212) 473-9708 fax

No.	Date	Revisions / Submissions
△	03/21/08	REVISION PER CELLAR ELEVATION CHANGE
△	09/18/07	SK-A16: REVISED FLOOR ELEVATION
△	04/02/07	COORDINATION/CLARIFICATION
△	12/06/06	CONTRACT DOCUMENT
△	11/17/06	BID ADDENDUM
△	10/06/06	BID ADDENDUM
△	09/18/06	BID DOCUMENT 100%
△	08/21/06	CONSTRUCTION DOCUMENT 100%

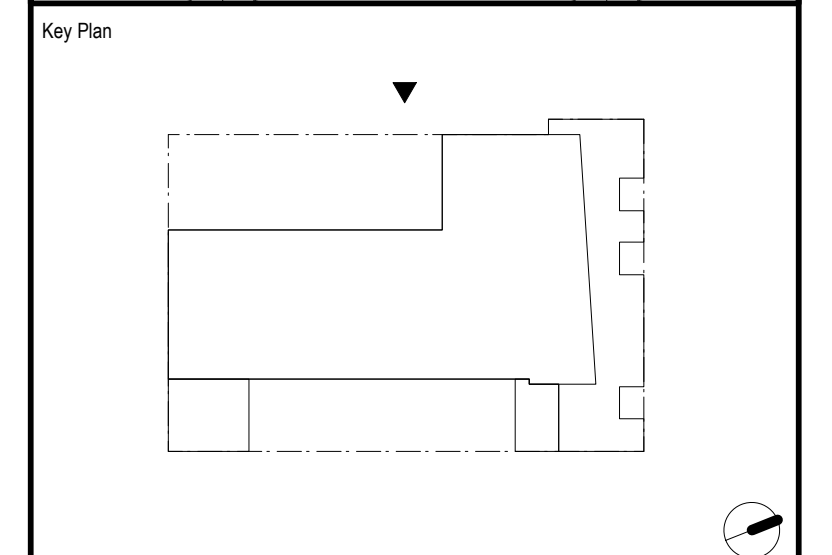
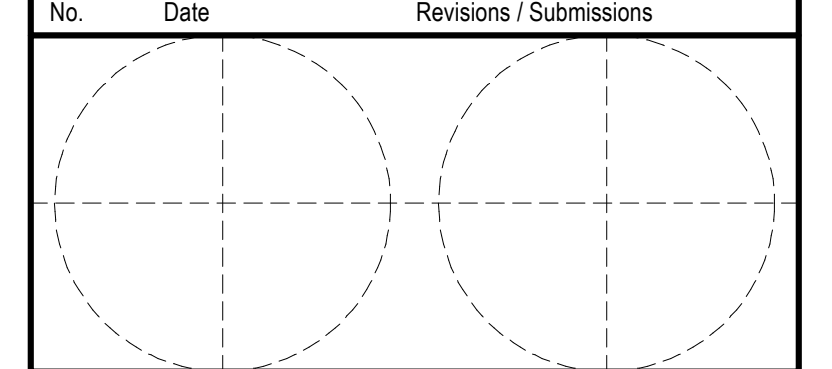

Project Title
The Pitt Street Residence
Common Ground Community
 133 Pitt Street
 New York, NY
 10002

Drawing Title Exterior Elevation West	
Date 09/18/06	Scale 1/8"=1'0"
Drawn By SA	Drawing No. A-201
Reviewed By CC	