

Architects:  
**Kiss + Cathcart, Architects**  
 44 Court Street, Tower C  
 Brooklyn, NY 11201  
 (718) 237-2786 phone / (718) 237-2025 fax

MEP Engineers:  
**Goldman Copeland Associates**  
 520 Eighth Avenue  
 New York, NY 10018  
 (212) 868-4660 phone / (212) 868-4680 fax

Structural Engineers:  
**Robert Silman Associates**  
 88 University Place  
 New York, NY 10003  
 (212) 620-7970 phone / (212) 620-8157 fax

Landscape:  
**Donna Walcavage Landscape and Urban Design**  
 212 Hicks Street  
 Brooklyn, NY 11201  
 (718) 834-0224 phone / (718) 834-9102 fax

Lighting:  
**AWA Architectural Lighting Designers**  
 504 LaGuardia Place, 5th Floor  
 New York, NY 10012  
 (212) 473-9797 phone / (212) 473-9708 fax

No.	Date	Revisions / Submissions
1	03/26/09	COORDINATION/CLARIFICATION
2	07/18/08	VAPOR MITIGATION SYSTEM
3	03/21/08	REVISION PER CELLAR ELEVATION CHANGE
4	04/02/07	COORDINATION/CLARIFICATION
5	12/06/06	CONTRACT DOCUMENT
6	11/17/06	BID ADDENDUM
7	10/06/06	BID ADDENDUM
8	09/18/06	BID DOCUMENT 100%
9	08/21/06	CONSTRUCTION DOCUMENT 100%

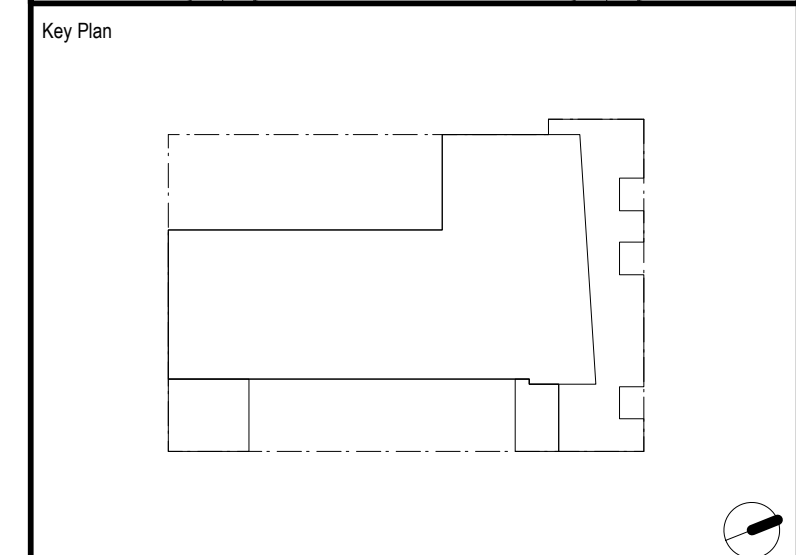
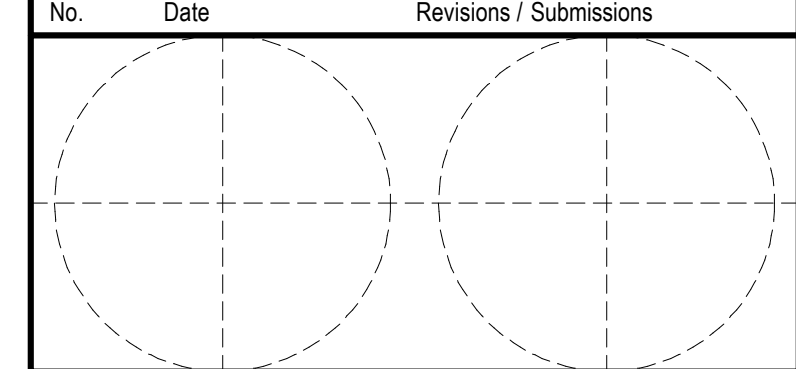

Project Title  
**The Pitt Street Residence  
 Common Ground Community**  
 133 Pitt Street  
 New York, NY  
 10002

Drawing Title  
**Exterior Elevations  
 North and South**

Date  
 09/18/06

Scale  
 1/8" = 1'-0"

Drawn By  
 SA

Drawing No.  
**A-202**

Reviewed By  
 CC